



WOODSIDE LANE BEXLEY KENT
DA5 1JL
GUIDE PRICE: £475,000 - £495,000 | Freehold



A spacious three-bedroom semi-detached home offering excellent potential to extend (subject to the relevant planning consents) and already benefiting from larger-than-average accommodation. An ideal choice for families, the property features a generous entrance/reception hall, two well-proportioned reception rooms, and a fitted kitchen. Upstairs, the first-floor landing leads to three good-sized bedrooms, a family bathroom, and a separate WC. The home is superbly positioned within walking distance of a wide range of popular amenities including local shops, Danson Park, highly regarded schools, Bexley Village, Albany Park Station, and convenient transport links. Externally, the property enjoys a front garden with off-street parking, a garage, and a sizeable rear garden—perfect for families and outdoor entertaining. Additional benefits include double glazing, gas central heating, and attractive high ceilings. Viewing is highly recommended.

Local Authority: Bexley
Council Tax Band: D

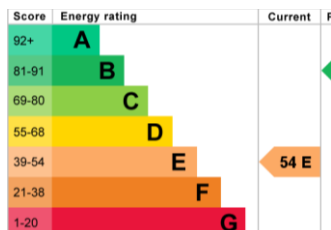

01322 553322

60-62 High Street, Bexley, Kent DA5 1AH
bexley@parkestates.co.uk
www.parkestates.co.uk

Woodside Lane

Approximate Gross Internal Area = 103.6 sq m / 1115 sq ft

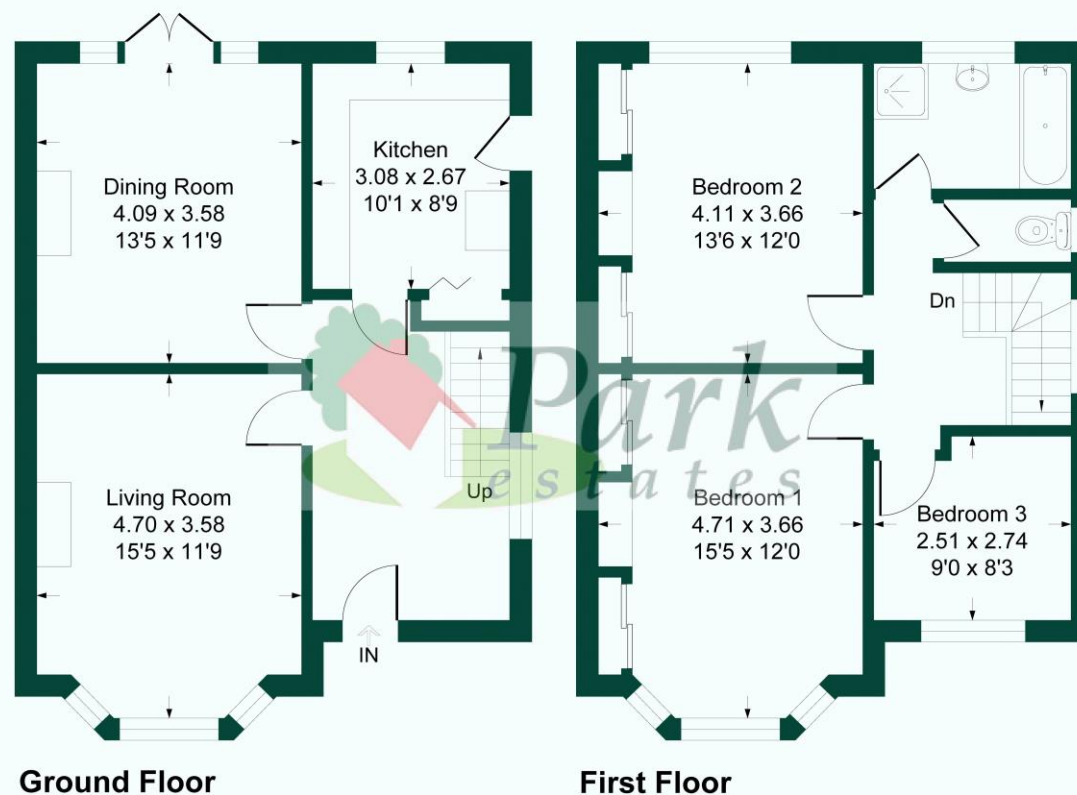

This plan is for layout guidance only. Not drawn to scale unless stated. Windows and door openings are approximate. Whilst every care is taken in the preparation of this plan, please check all dimensions, shapes and compass bearings before making any decisions reliant upon them.
Produced By Planpix

Every care has been taken with the preparation of details, but accuracy is in no way guaranteed. These particulars do not constitute a contract and are issued and accepted on the express understanding that all negotiations will be conducted through Park Estates. The seller does not make or give, nor do we or our employees have any authority to give a representation or warranty in relation to the property. Please contact this office before viewing the property. If there is any point which is of particular importance to you, we will be pleased to check the information for you and confirm that the property remains available. This is particularly important if you are contemplating travelling some distance to view the property. We would strongly recommend that all the information that we provide about the property is verified by yourself on inspection and also by your conveyancer, especially where statements have been made by us to the effect that the information provided by us has not been verified.